

SPECIFICATIONS	
SENSITIVITY	UNIDIRECTIONAL
ACTUATE G LEVEL RANGE	5.0 to 5000 G'S
STANDARD TOLERANCE	±10%
CONTACTS	S.P.S.T. N.O.
INSULATION RESISTANCE	1000 MEGOHMS @ 500 VDC
CONTACT RATING	0.5A @ 28 VDC
RESPONSE TIME	LESS THAN 1.0 ms @ 1000 G'S
OPERATING TEMPERATURE	-55 °C TO +125 °C
TERMINATION	AXIAL WIRE LEADS
SEAL	HERMETIC 1X10-8 CC/SEC
WEIGHT	1.0 GRAM

- PART NUMBERS:
INCLUDE THE DESIRED "G" LEVEL AS PART OF THE BASIC MODEL NUMBER. FOR EXAMPLE: SPECIFY 9TO-967-100G FOR A TRIGGER LEVEL 100 TIMES GRAVITY.

- STANDARD G LEVELS:

9TO-967-100G
9TO-967-500G
9TO-967-1000G
9TO-967-2000G

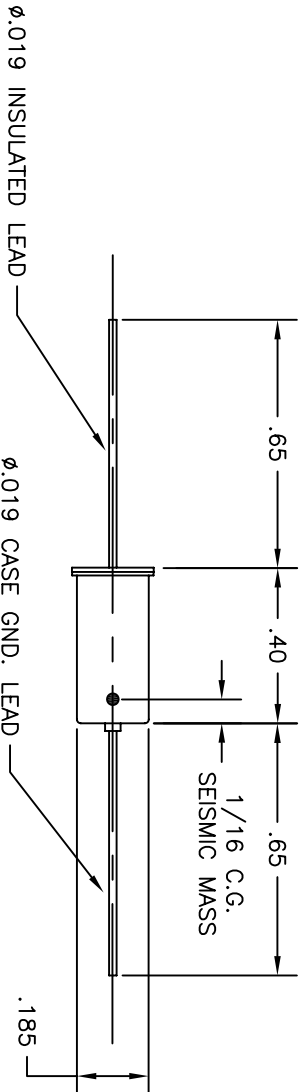
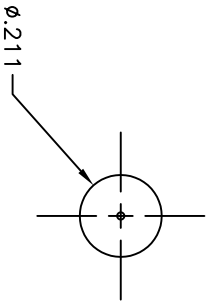
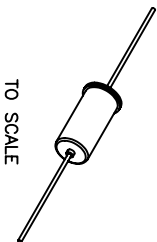

DIRECTION OF ACCELERATION TO
CLOSE CONTACTS

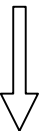

UNLESS OTHERWISE SPECIFIED:
BREAK ALL SHARP EDGES .005" X 45°
#64 MACHINE FINISH.
ALL DIMS. TO BE MET AFTER PLATING.
DIMENSIONS ARE IN INCHES.

SYMBOLS:
● CRITICAL DIMENSION
⊳ TEXT NOTE

TOLERANCES:
DEC .XX ±.010
DEC .XXX ±.005
FRA 1/64 ±.005
ANG ±.1°
DIA CONC. ±.005

TITLE
OUTLINE 9TO-967

MATERIAL

FINISH

HEAT TREAT

QTY

DWN.

Inertial Switch
INCORPORATED

ORANGEBURG, NEW YORK
CAGE CODE: 21928

DWG NO. A21611

REV A

REV	ADDED 1/16 C.G.	4/14/05	23882	BUD
REV	DESCRIPTION	DATE	CO. NO.	CHK'D
	REVISIONS			

USED ON	9TO-967	NEXT ASSEM.	1
---------	---------	-------------	---

DWN.	BD 3/17/05	CHK'D	ATS 3/18/05	APPR'D	BUD 3/18/05	SCALE	2:1
------	------------	-------	-------------	--------	-------------	-------	-----